

REVISION CONTROL			
REV.	DESCRIPTION	BY	DATE
-	RELEASED TO CUSTOMER	LAV	06/28/11

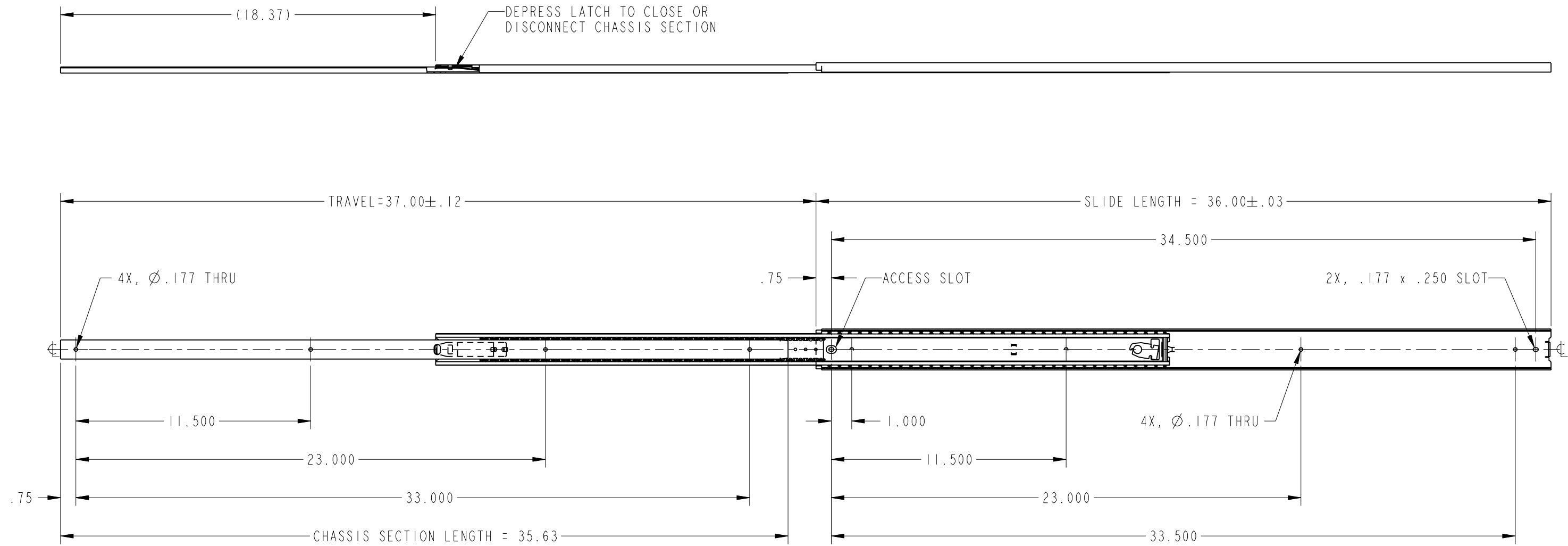

- 8. SLIDE IS SYMMETRICAL, MAY BE USED AS A LEFT OR RIGHT HAND SLIDE.
- 7. SLIDE IS PROVIDED WITH LOCK OPEN AND QUICK DISCONNECT OF CHASSIS SECTION.
- 6. CUSHIONED CLOSED POSITION STOP.
- 5. BALL RETAINER: COLD ROLLED STEEL. BRIDGED FOR TRU-TRACKING.
- 4. BALL SPACERS: HIGH IMPACT EXTRUDED PLASTIC.
- 3. LUBRICATION: EXTREME PRESSURE, HI-LOW TEMPERATURE POLYMER GREASE.
- 2. CHANNEL FINISH: ZINC PLATE.
- 1. CHANNEL MATERIAL: COLD ROLLED STEEL.

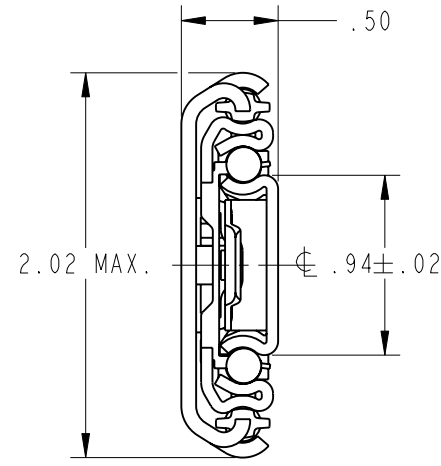

END VIEW

PROPRIETARY ITEM
 These drawings contain information deemed PROPRIETARY to Jonathan Engineered Solutions and may not be copied in whole or in part without express written permission from Jonathan Engineered Solutions.

DATE	CUSTOMER APPROVAL
-----	-----

410 Exchange, Suite 200
 Irvine, CA 92602-1309
 Tel: (714) 665-4400
 Fax: (714) 368-7002

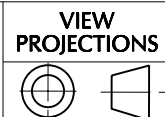

TOLERANCES UNLESS OTHERWISE NOTED

.XX	.XXX	ANGLES	HOLES	SHEET
±.03	±.010	±2° 00'	±.005	1 OF 1

DWG. NO.	JONATHAN	REV. -
	370QD-36	