

- NOTES:**
1. WHEN ORDERING WITH LOCK, SPECIFY L.H. OR R.H.
(EX: 150-12L, 150-12R)
(LEFT SLIDE AS SHOWN, RIGHT SLIDE OPPOSITE.)
 2. FOR BRACKETS, SEE SEPARATE SECTION.
 3. SLIDE IS PROVIDED WITH LOCK TYPE "E"
LOCKS IN OPEN POSITION ONLY. (OPTIONAL)
 4. MOUNTING HOLE TOLERANCE: $\pm .005$
 $\pm .13$

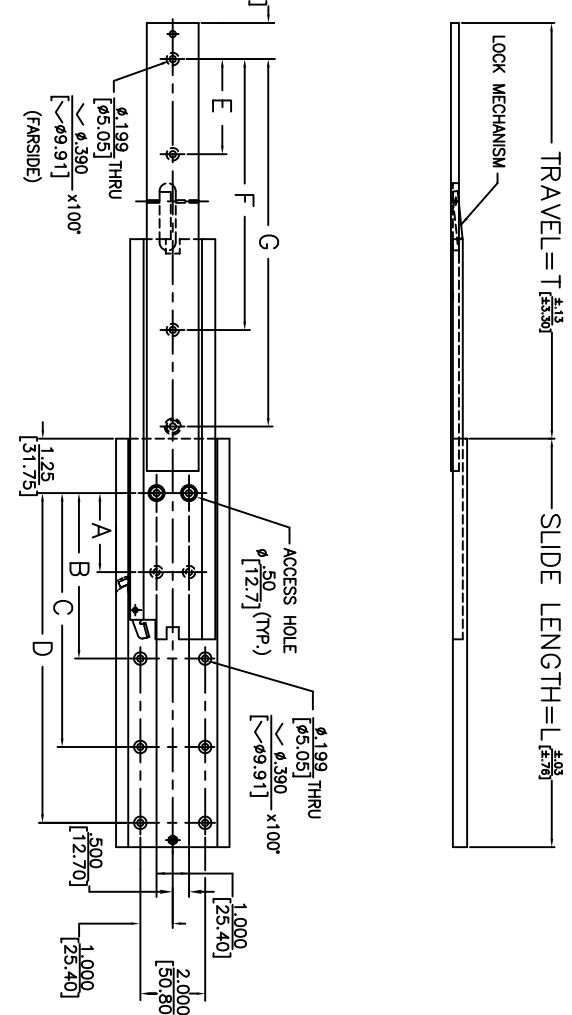
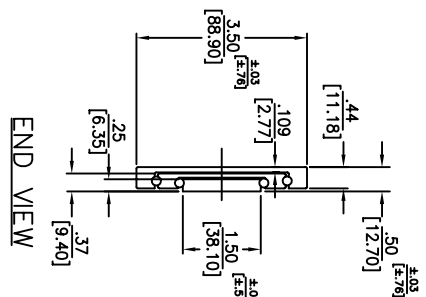
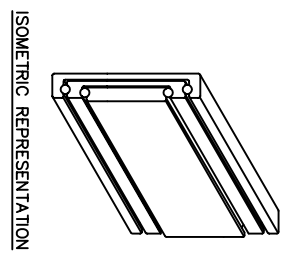

PART NO.	SERIES	SLIDE LENGTH		MOUNTING HOLE PATTERN				LOAD RATING					
		DIM.	TRAIL	OUTER MEMBER	INNER MEMBER	PER PAIR							
LENGTH	L	T	A	B	C	D	E	F	G				
150-10	10	25	228.6				7.7	20.0	2	1.5	8	8	240 LBS
150-12	12	25	228.6				7.7	20.0	2	1.5	8	8	240 LBS
150-14	14	25	228.6				7.7	20.0	2	1.5	8	8	240 LBS
150-16	16	25	228.6				7.7	20.0	2	1.5	8	8	240 LBS
150-18	18	25	228.6				7.7	20.0	2	1.5	8	8	240 LBS
150-20	20	25	228.6				7.7	20.0	2	1.5	8	8	240 LBS
150-22	22	25	228.6				7.7	20.0	2	1.5	8	8	240 LBS
150-24	24	25	228.6				7.7	20.0	2	1.5	8	8	240 LBS
150-26	26	25	228.6				7.7	20.0	2	1.5	8	8	240 LBS
150-28	28	25	228.6				7.7	20.0	2	1.5	8	8	240 LBS
150-30	30	25	228.6				7.7	20.0	2	1.5	8	8	240 LBS
150-32	32	25	228.6				7.7	20.0	2	1.5	8	8	240 LBS
150-34	34	25	228.6				7.7	20.0	2	1.5	8	8	240 LBS
150-36	36	25	228.6				7.7	20.0	2	1.5	8	8	240 LBS

Jonathan Engineering Solutions

Irvine Technology Center
410 Exchange, Suite 200
Irvine, CA 92602
Tel: (714) 665-4400

Website: www.jonathanengr.com
 Engineering • Production • Integration • Subassembly • Logistics
 United States • Mexico • China • Taiwan

DIMENSIONS SHOWN AS: INL [MM] TOLERANCE UNLESS OTHERWISE NOTED .XX ±.010 .XXX ±.005 .XX ±.13 ANGLES ±1°	PART NO. 150 DATE: 6/04	DESCRIPTION: ALUMINUM SERIES 150 LOAD RATING: 136-265 LBS. / 61-120 KG.
---------------------------------------------------------------------------------------------------------------------------	----------------------------	----------------------------------------------------------------------------------