

**PRELIMINARY RELEASE**

REMOVE THIS SCREW AND RUBBER BUMPER TO FREE THE CHASSIS MEMBER FOR REMOVAL  
 NOTE: SCREW REMOVES FROM THE TOP ON THE LEFT HAND SLIDE AND FROM THE BOTTOM ON THE RIGHT HAND SLIDE.

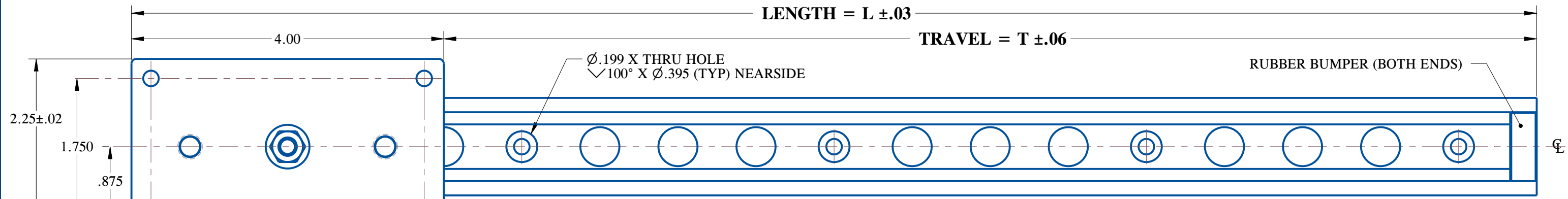
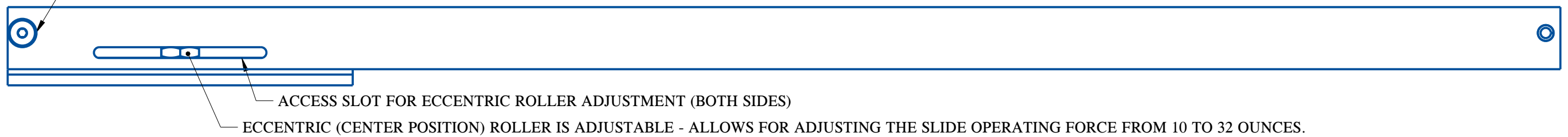

**ORDERING INFORMATION**

**V330LM-B-XX-P**  
 V-ROLLER LINEAR MOTION SLIDE SERIES  
 B = BLACK  
 BLANK = CLEAR  
 SLIDE LENGTH  
 P = PAIR  
 BLANK = SINGLE SLIDE

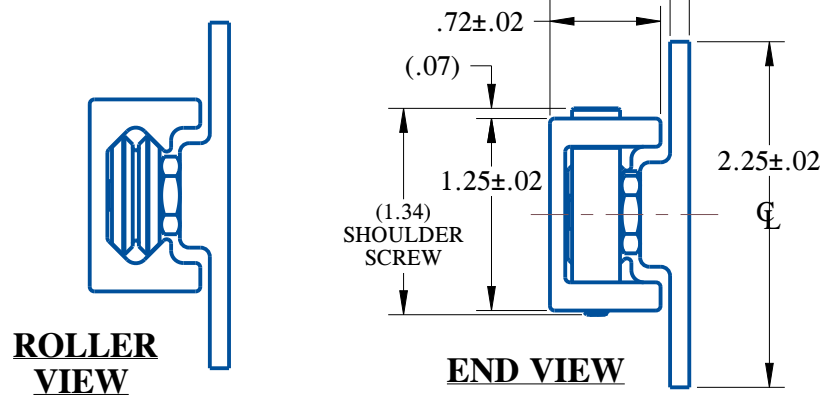

1. MATERIAL: CHANNELS ARE HIGH STRENGTH ALUMINUM ALLOYS-TENSILE STRENGTH 35,000 PSI PER ASTM B221 COMPONENTS ARE CORROSION RESISTANT STEEL, CARBON STEEL AND RUBBER.
2. FINISH: CHANNELS ARE ANNOIDIZED PER MIL-A-8625, TYPE II CLASS 1 (CLEAR) OR TYPE II CLASS 2 (BLACK) CRES PARTS ARE PASSIVATED. STEEL PARTS ARE ZINC PLATED ROHS COMPLIANT.
3. HOLES OTHER THAN SHOWN MAY BE IN THE SLIDES MEMBERS AT JONATHAN'S OPTION.
4. USE #10 X 100° FLAT HEAD MACHINE SCREWS FOR MOUNTING THROUGH THE SLIDE MEMBERS.
5. SLIDE FEATURES 3 ROLLERS, TWO ARE CONCENTRIC AND ONE IS ECCENTRIC FOR FIT ADJUSTMENT.

SLIDE LENGTH	LENGTH	TRAVEL	CABINET MEMBER		SLIDE WEIGHT
	L	T	A	MOUNTING HOLE COUNT	LBS / EACH
V330LM-12	12.00	8.00	8.000	3	.70
V330LM-14	14.00	10.00	12.000	4	.78
V330LM-16	16.00	12.00	12.000	4	.87
V330LM-18	18.00	14.00	16.000	5	.95
V330LM-20	20.00	16.00	16.000	5	1.04
V330LM-22	22.00	18.00	20.000	6	1.12
V330LM-24	24.00	20.00	20.000	6	1.21
V330LM-26	26.00	22.00	24.000	7	1.29
V330LM-28	28.00	24.00	24.000	7	1.38
V330LM-30	30.00	26.00	28.000	8	1.46
V330LM-32	32.00	28.00	28.000	8	1.55
V330LM-34	34.00	30.00	32.000	9	1.64
V330LM-36	36.00	32.00	32.000	9	1.72

**JONATHAN**  
Engineered Solutions

Irvine Technology Center  
 250 Commerce, Suite 100  
 Irvine, CA 92602  
 Tel. (714) 665-4400  
 Fax: (714) 368-7002  
 Website: www.jonathanengr.com  
 Engineer - Production - Integration/ Subassembly - Logistics  
 United States - Mexico - China - Taiwan

TOLERANCES UNLESS OTHERWISE NOTED				PART NUMBER : <b>V330LM</b>		DESCRIPTION :	
.XX .XXX ANGLES HOLES				DATE : 06/8/20		<b>MATERIAL: ALUMINUM</b> <b>SERIES: V330LM</b> <b>LOAD RATING: TBD</b>	
±.01 ±.005 ± 1° ± .005				SHEET 1 OF 1			
COPYRIGHT © 2012 JONATHAN ENGINEERED SOLUTIONS							